



EAGLE

PAN TILT SYSTEMS



PT-220HD pan tilt head with Hitachi Z-3000W switchable format camera

The EAGLE® PT-220HD pan-tilt head is a heavy-duty, yet quiet and easy to use unit. It is designed for use in many areas, some of which are studio broadcast operation, worship venues, teleconferencing, and distance learning.

The PT-220HD's large size allows for the usage of the larger sized ENG type cameras in studio configuration, with or without teleprompters attached. The side mount design allows for cameras to be placed on either side of the head depending on user conditions and camera styles.

The head has excellent motion characteristics at any speed, with a range of motion of 355° in pan and 180° in tilt. The unit has three overall speed ranges, variable from 0° to 9° per

EAGLE® PT-220 HD PAN TILT HEAD

Eagle® system compatible with on board RISC computer control

Remote control via RS-485 protocol using standard 3 wire connect, or over optional modem or fiber optic link

Worm gear driven for smooth, accurate, repeatable performance

Uses DC motors controlled by pulse width modulation for excellent low speed torque

Motors are isolated from body by elastomeric polymer compounds for noise reduction

Vector solving operation in manual or preset modes

64 presets per head, stored internally in non-volatile memory

Will handle camera ,lens, and LCD prompter combinations weighing up to 40 lbs.

Built in 12VDC camera power supply

Optional camera control module for integrated remote camera control of selected Hitachi cameras using Eagle® system controllers, PC software, or AMX and Crestron control systems

Control software available for Windows 95™/98, and Windows NT™ or 2000™ compatible PC's

SOLDERLESS Removeable 5 pin connector in base allows for easy connection of power and control

Control, video and genlock connections made at base are passed through head to camera –no cables to get caught when panning or tilting

Pre-built camera control /power harness, and adjustable camera mount provided with each head

All needed connectors for power and control are included

second in both pan and tilt. Backlash is adjustable to near zero to compensate for wear. Speed is completely variable from zero to full based on proportional digital joystick input from the optional PT-C, PT-C55, or PT-TSC2 controllers .

Up to 64 different preset combinations of pan tilt position and lens settings can be memorized by the head. All are stored in non-volatile memory inside each head, and can easily be recalled at any time.

The Eagle® PT-220HD is for camera / lens / LCD prompter combinations of up to 40 pounds (18 kg).

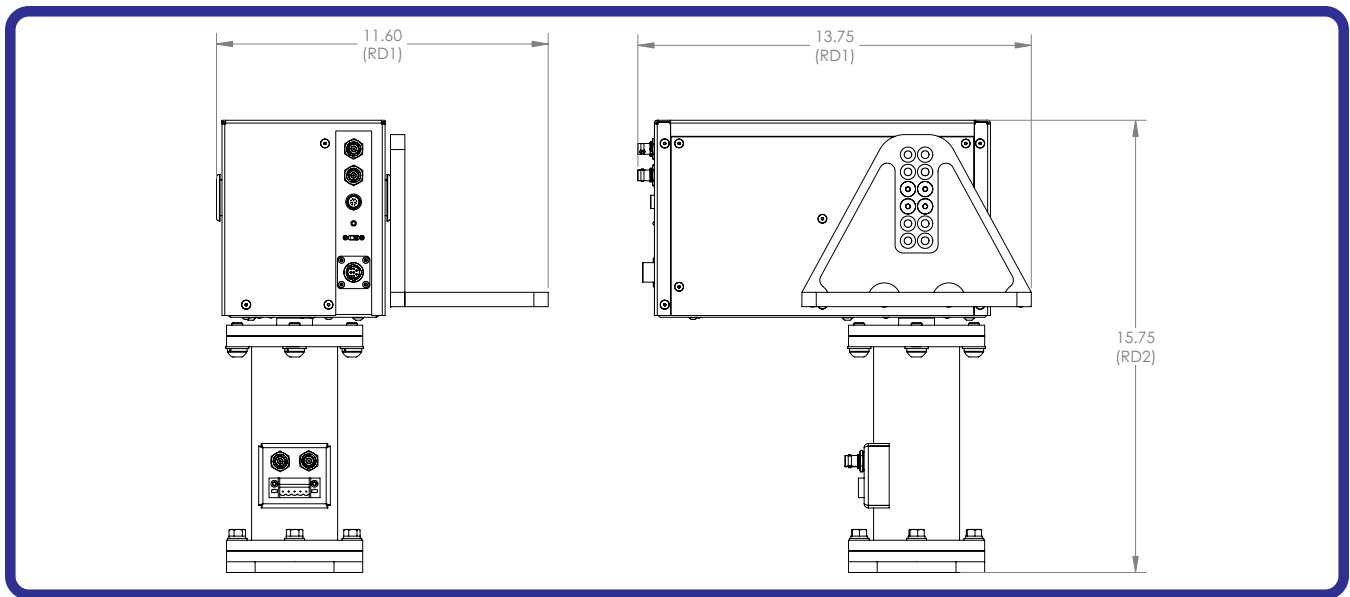

SPECIFICATIONS

Weight: 25 pounds (11.3 kg)

Maximum load: 40 pounds (18.2 kg); including camera/lens and LCD prompter

Pan range: ± 178 degrees

Tilt range: ± 90 degrees

Pan and tilt speed: 0 to 9° per second, variable.

Accuracy of preset position recall: ± 5 arc minutes (.083 degrees)

Max. number of preset positions: 64

Requires 24VDC power, minimum 2A: max draw with camera: 3.5A; provides camera power of up to 12 VDC @ 3A

Worm gear drive with high-torque DC PWM (pulse width modulated) motor control

Uses RS-485 communications protocol; optional RS-232 or fiber optic link adapters available

Optional PT-AAM modem allows remote control of heads via dial-up phone line

OPTIONAL ACCESSORIES

PT-TSC2 desktop touch screen pan-tilt, lens, and camera controller

PT-C desktop joystick pan tilt and lens controller

PT-CC desktop camera controller

PT-CCB camera control module (internal option in head)

PT-PS-3 single 6.5A output power supply

PT-SB shot box, motion control recorder

PT-T2 one input, six output control and power splitter box

PT-RSA RS232 to RS485 adapter; for controlling Eagle system via PC

PT-AAM Auto answer modem, includes one PT-RSA

PT-MP-1 control multiplexer; allows multiple controllers on single RS-485 backbone

PT-CSI contact closure interface

PT-MFA multi function adapter interface

Distributed by Hitachi Kokusai Electric America, Ltd.
150 Crossways Park Dr. Woodbury NY 11797
Call (516)921-7200 for a dealer near you

Eagle™ products are designed and manufactured in the USA by Display Devices Inc., Arvada CO USA 80003

Specifications and design subject to change without notice

01/07

www.eaglepantilt.com



EAGLE
PAN TILT SYSTEMS
Helping to bring your world
into focus